

## WB121ECB OPTICAL FIBRE ENCLOSURE (Supporting upto 24 Fibres)

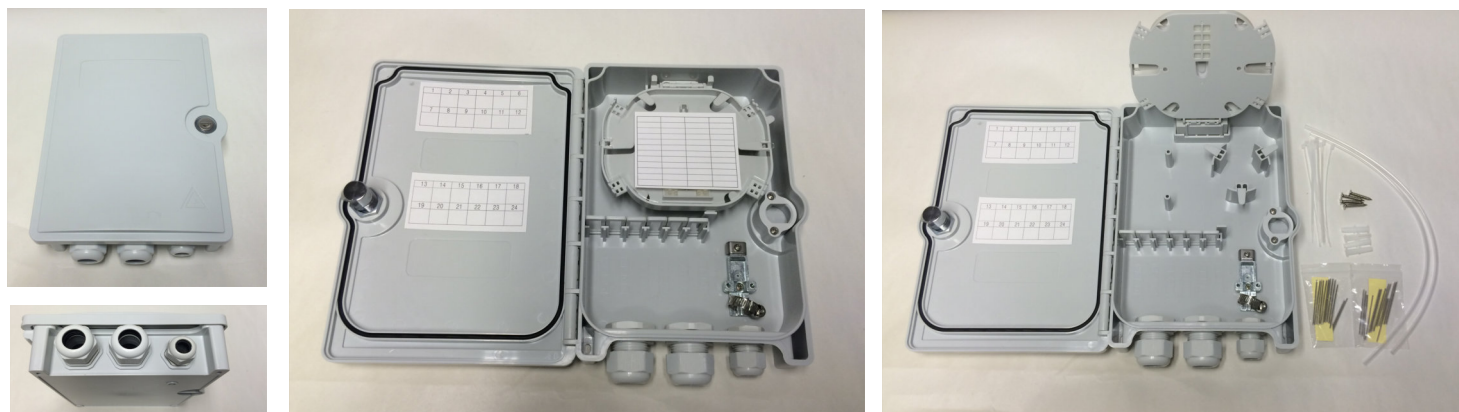

This IP65 lockable enclosure offers the ability to terminate 24 fibres housed in a strong robust ABS enclosure for indoor and outdoor applications.

The enclosure can accept a number of adapter types, with are two outgoing and one incoming cable entry points that are sealed to ensure the IP65 rating is protected once installed.

There are integrated cable tie positions and fibre bend radius protection integrated. Both the front lockable door and splice tray are detachable to enable an easier installation.

### Features:

- Supports up to IP65
- Supports up to 24 fibres
- Hinged / removable splice tray assists installation
- Multiple adaptor options available
- Secure lockable front door
- Supplied with fibre transit tubing wall fixings and tie wraps
- Integrated bend radius

### Applications:

Data centres, Premise / Telecommunication networks, Ethernet, Fibre Channel, ATM, LAN, MAN and WAN

Data communication and telecommunication networks

### Product Specifications:

IP Rating	IP65
Height	258mm
Width	186mm
Depth	61mm
Net Weight	0.085kg
Package Weight	0.96kg
Packaged Dims	275mm x 197mm x 65mm
Colour	White (RAL 7035)
Material	ABS

Designed in accordance with:  
TIA/EIA 568.C, ISO/IEC 11801, EN50173,  
IEC 60304, IEC 61754

### Ordering Information:

Description	Part Number
24 Fibre Enclosure	WB121ECB

### Also Available:

Patchcords  
Pigtails  
Pre-Terminated assemblies  
Splice protectors  
Fibre optic cutting tools

- For further information please contact one of our sales advisors
- WrenUk reserves the right to make changes to product specifications in the datasheet(s) at any time without notice.
- Information in this document is correct as of May 20, 2016

Europe Sales Office(s)  
E: [info@wren.com](mailto:info@wren.com)  
T: +44 (0) 1908 951000  
T: +44 (0) 1373 858466

